

Director District #2

At the intersection of school district and Enumclaw-Buckley Road.
 Northeast on Enumclaw-Buckley Road to Semanski Street.
 North on Semanski Street to Warner Ave.
 East on Warner Avenue to Charwila Lane.
 North on Charwila Lane to Harmony Lane.
 East and north on Harmony Lane to Scandia Ave.
 East on Scandia Ave. to Myrtine Street.
 North on Myrtine Street to Roosevelt Ave.
 West on Roosevelt Ave. to McKinley Street.
 North on McKinley Street to Elmont Ave.
 West on Elmont Ave. to Semanski Street.
 North on Semanski Street to Griffin Ave.
 East on Griffin Ave. to Porter Street.
 Southwest on Porter Street to Monroe Avenue.
 Southeast on Monroe Ave. to Roosevelt Ave. "448th Street".
 East on 448th Street to Enumclaw-Chinook Pass Road.
 Easterly on Enumclaw-Chinook Pass Road to E Twin Creek.
 North on E Twin Creek to National Forest Road 7120.
 Easterly on National Forest Road 7120 to Slippery Creek.
 South on Slippery Creek to school district.
 Westerly on school district to point of beginning.

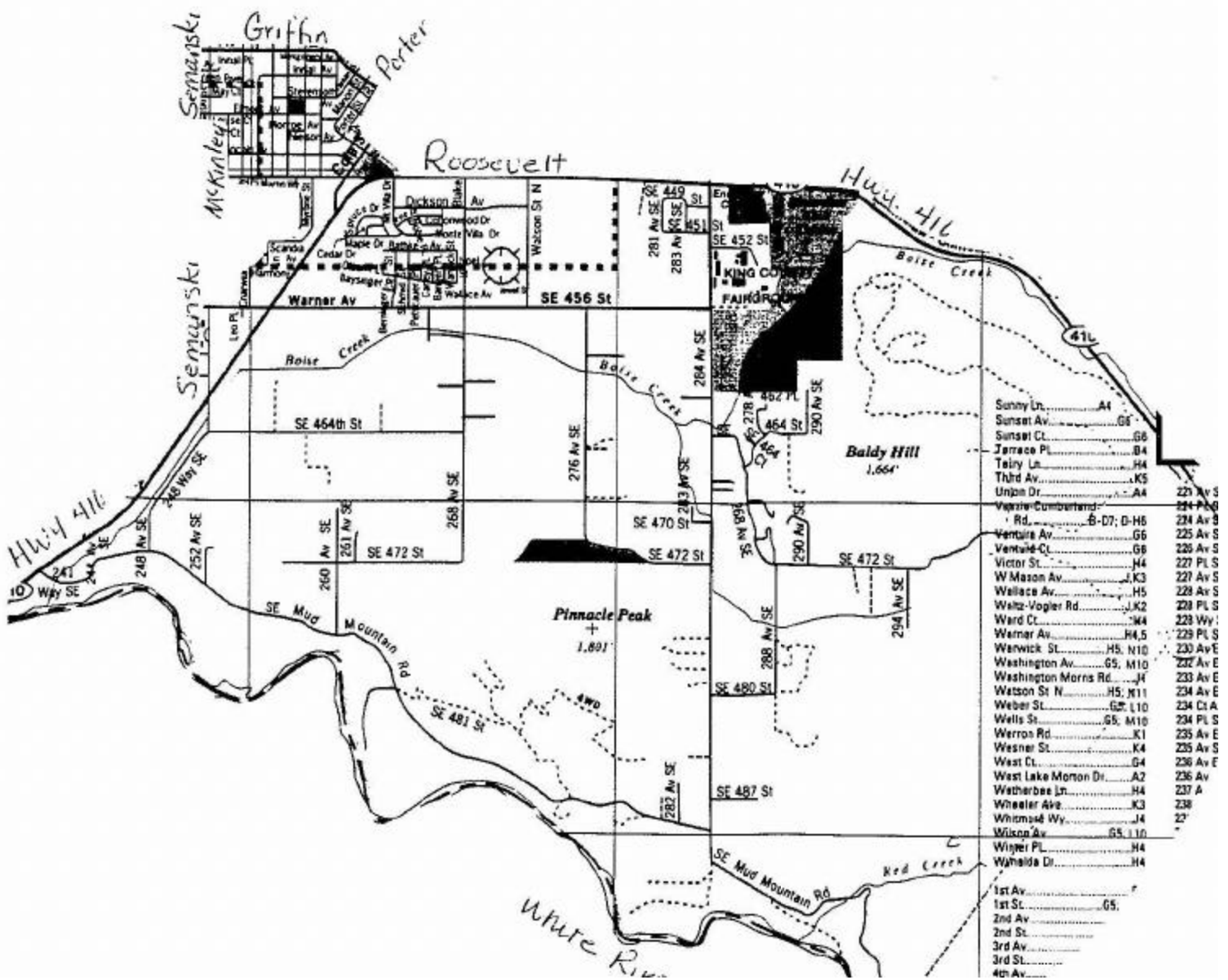

11
12
13
14
15
16
17
18
19
20
21
22
23
24
25
26
27
28
29
30
31
32
33
34
35
36
37
38
39
40
41
42
43
44
45
46
47
48
49
50
51
52
53
54
55
56
57
58
59
60
61
62
63
64
65
66
67
68
69
70
71
72
73
74
75
76
77
78
79
80
81
82
83
84
85
86
87
88
89
90
91
92
93
94
95
96
97
98
99
100

- 54

W
Mud
Mar
5th Av
St

